

NOTES:

1. SUBSTRATE: N-BK7
2. ROHS COMPLIANT
3. CENTERING TOLERANCE (AT 587.6nm):
BEAM DEVIATION (HALF ANGLE): <1 ARCMIN
4. COATING (APPLY ACROSS CLEAR APERTURE)

S1&S2: Rabs <0.25% @ 1550nm

△ FINE GRIND SURFACE

6. POWER, IRREGULARITY, AND SURFACE QUALITY
SPECIFICATIONS APPLY ACROSS CLEAR APERTURE
7. FOCAL LENGTH (EFL): 100.00 mm±1%
BACK FOCAL LENGTH (BFL): 96.01 mm
8. PROTECTIVE BEVEL AS NEEDED
9. DESIGN WAVELENGTH: 587.6nm

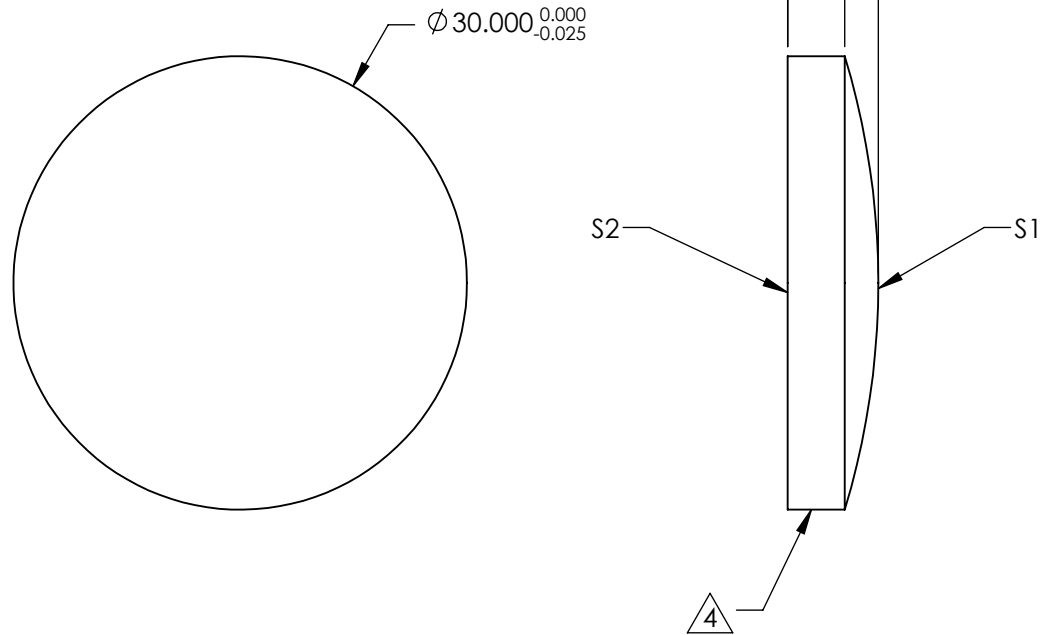
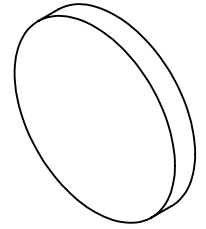

**FOR INFORMATION ONLY:
DO NOT MANUFACTURE
PARTS TO THIS DRAWING**

SPECIFICATIONS SUBJECT TO CHANGE WITHOUT NOTICE
DIMENSIONS ARE FOR REFERENCE ONLY

| | S1 | S2 |
|-----------------|---------------------|---------------------|
| SHAPE | CONVEX | PLANO |
| RADIUS | 51.68 | INFINITY |
| SURFACE QUALITY | 40-20 | 40-20 |
| CLEAR APERTURE | $\phi 29.00$ | $\phi 29.00$ |
| BEVEL | PROTECTED AS NEEDED | PROTECTED AS NEEDED |

THIRD ANGLE PROJECTION

ALL DIMS IN mm

Edmund Optics®

TITLE

30.0mm Dia. x 100.0mm FL 1550nm V-Coat,
Plano-Convex Lens

DWG NO

26172

SHEET
49 OF 54